

## 2024 MN-DONA Spring Connection Schedule

Holiday Inn & Suites

200 West First St. Duluth, MN 55082

Pending approval by MN-BELTSS for 8.5 Credit Hours

### Wednesday, May 8

12:00pm **Registration opens** *Lyric Pre-Function*

12:15pm-1:15pm **Committee meetings** *Lyric Conference Center*

Open to all members, please RSVP to [sarah@bestmeetings.com](mailto:sarah@bestmeetings.com) for lunch.

1:30pm-3pm **Assessment on Dementia & Relationships/Intimacy (AL/SNF)**

*Kari Everson – LeadingAge Minnesota & Rob Rode – VRB Law*

*Room: Lyric Conference Center*

This session will be a more hands-on follow-up session to the 2022 Fall Conference panel on dementia and relationships/intimacy, and will explore assessment questions and options for assistance in determining capacity and consent.

3:15pm-4:45pm **Financial Lookouts – Elder Abuse (AL/SNF)**

*Jason Darger & Heather Saville – US Bank, Amanda Thorson – Hilltop HCC*

*Lyric Conference Center*

This session will cover financial education and various scams (online, gift cards, romance, etc.) that target elders, and what to look for to protect residents from financial abuse.

4:45 pm – 6:15 pm **Exhibit Hall & Networking Event** *Great Lakes Ballroom*

Hosted Bar Sponsored by EverCare Consulting

7pm – 10:30pm **Free Time/Hotel Hangout** *Harbor Room #415*

### Thursday, May 9

8am- 9am **Continental Breakfast** *Room: Superior/Michigan/Huron*

9 am-10:30am **Breakout sessions**

- **What's New in 2024: MDS Updates (SNF)** *Colleen Toebe- Pathway Health*

*Superior/Michigan/Huron*

The MDS 3.0 controls reimbursement, quality measures, survey and compliance, QRP and VBP programs. This engaging presentation will walk operational and clinical leaders through the specific MDS changes in 2024.

- **Waivered Services/Customized Living Tools (AL)** *Julie Dietz - Senior Care Solutions*

*Lyric Conference Center*

Waivered Services Programs in Assisted Living: Medicaid waived services programs serve as a key component of assisted living reimbursement, impacting your community's financial stability and capacity to deliver care and services. In this session, gain a comprehensive understanding of how waived services are managed and explore strategies to maximize reimbursement opportunities for your organization.

## Thursday, May 9 *Continued*

11am-12:30pm Breakout sessions

- **Can we Prevent Falls? Using QAPI to do Just That!** *Colleen Toebe – Pathway Health Superior/Michigan/Huron*

This information-packed session will provide tips and techniques on the investigative process of accidents and injuries and will assist in the development of concrete processes in conducting a successful investigation.

- **Creative and Meaningful Education: Building Nursing Competencies** *Daniel Billings – Pathway Lyric Conference Center*

Education can be fun and rewarding for the adult learner when it is organized, meaningful, and presented in a way that sticks! This session will provide workable strategies for creating a simple but meaningful education session for staff in post-acute care.

12:30 pm - 1:00 pm **Lunch** *Superior/Michigan/Huron*

1:00 pm - 1:30 pm **Annual Meeting**

- President's/District/Committee Reports
- Election Results
- Will present AL Nurse Leader of the Year & Personal Balance Scholarship

1:30pm-2:30pm **District Meetings** *Lyric*

Open to all attendees, worth 1 CEU

2:45pm-4:15pm **Breakout Sessions**

- **AL Survey Updates** *Michaun Shetler - Care Providers Lyric Conference Center*

The program will allow individuals to gain insight into the top 10 ALF correction orders and common survey trends. It will provide valuable information to assist providers in reviewing current practices and achieving regulatory compliance that will impact their AL Report Card ratings in the near future.

- **SNF Survey Updates: Understanding F-tags** *Kari Everson – LeadingAge Minnesota*

This is a comprehensive overview of the most commonly cited nursing home deficiencies and will explore best practices and strategies for achieving compliance.

4:15pm **Event ends** *Collect CEUS at registration desk*

## Conference Map

The Lyric Conference Center is down one floor from the front desk and the Great Lakes Ballroom is down two floors.

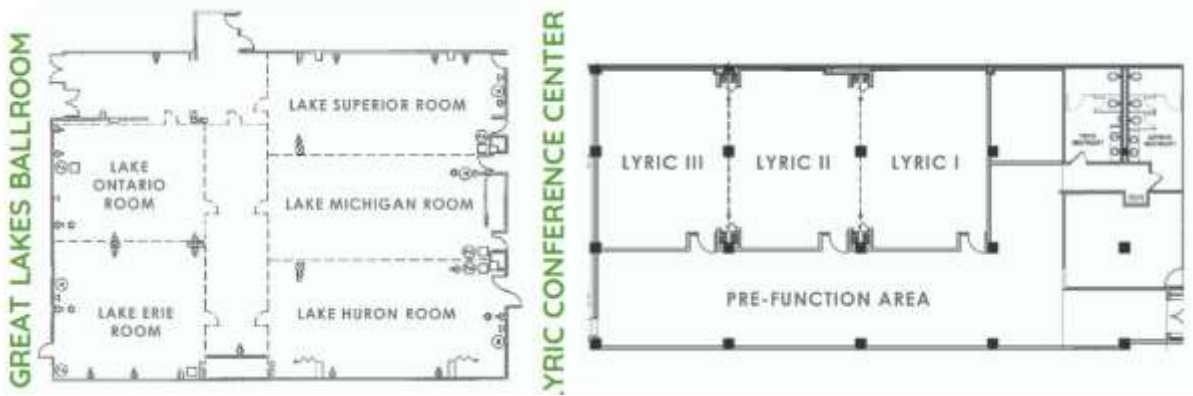

Duluth Skywalk Map is attached to email